



web: www.crescentparc.co.in • email: info@crescentparc.co.in



Home loans available from DHFL-PSB Joint Venture*
Project Marketed by - DHFL Property Services Ltd.

Disclaimer:
• This brochure and its contents are only for the purpose of promotion of the Company and the same is not an offer for sale of apartments. The Company, its directors, officers, employees and its associates shall not be responsible or liable for any action if any person takes on the basis of the contents of this brochure.
• Interior designing relates to the internal space planning in the apartments and does not imply the inclusion of furniture and fixtures.
• The content of this brochure are purely conceptual and do not represent in any manner a legal offering or promise. The plans shown in this brochure are schematic.

*Conditions apply.



For some, this is a leap into the future.
For some, this is about returning to the roots.



Crescent ParC
AMRITSAR

Only
10 minutes
from
Golden Temple.

Free
Shuttle service
from township
to Darbar Sahib

Secure gated
community

Facility
management
services

No Pre EMI
till possession*.

*Conditions apply.



Reside close to your heart

Because your lifestyle is international,
and your values are traditional.



Crescent ParC
Ashberry
HOMES

If home means Punjab, if home means Amritsar, if home means a return to the roots, if home means a connect with the future, your prayers have been answered.

Crescent ParC - a way of living that blends the finest in international living, with values and traditions that are homegrown; a design that fosters community living and a sense of belonging. After changing the way Ghaziabad and Gurgaon live, Crescent Parc, spread over 100 acres (approx) is all set to define new standards in Amritsar

A part of this splendid township is 'Ashberry Homes' - the 'limited edition' phase spread on 5.12 acres. On offer are the state of the art built villas and 1,2,3 bedroom apartments.

Be a part of the prestigious address of Amritsar. Be a part of Ashberry Homes.



Ashberry Homes - A 'new world' that will emerge, as a destination, and an address that marks a statement.

Relax and Rejuvenate

Club
Gymnasium
Swimming Pool

Convenient Amenities

Lifts
24 hrs Treated Water Supply
Power Backup
Professional Facility Management Services

Eco-Friendly Designs

Large open spaces
Pollution Free Environment
Rain Water Harvesting

Education and Healthcare:

Proposed International High School
Proposed Primary and Nursery School
State of the art healthcare facility

Developed Infrastructure

Efficient Water Management
Wide well lit metal roads
Gated secure complex
Sewage treatment plant



specifications

Living/ Dining	Flooring	: Vitrified tiles
Bedrooms	Flooring	: Vitrified tiles/laminated wooden flooring
	Wall finish	: Oil bound distemper in pleasing shades
	Ceiling	: Oil bound distemper
	Window	: Powder Coated / Anodised Aluminium Frame Windows
	Main Door	: Polished Hardwood Frame with Moulded Skin Door
	Internal Doors	: Painted Hardwood Frame with Moulded Skin Doors/Flush doors
	Chinaware	: Parryware or equivalent
	C.P. Fittings	: Modern and Elegant
Kitchen	Flooring & Dado	: Ceramic Tiles
	Platform	: Granite Counter
	Wall finish	: Ceramic tiles 2 ft above the counter and Oil bound distemper in pleasing shades
	Other	: Stainless steel sink with drain board
Toilet	Wall finish	: Combination of Ceramic tiles and oil bound distemper in pleasing shades & mirror
	Counter	: Polished granite in master bedroom toilet
	Flooring	: Ceramic Tiles
	Fittings	: ISI standard Washbasin and WC's. Chrome Plated tap fittings of standard make with Shower
Electrical	: Copper wiring with modular switches. Circuits with MCB's approved make.	
Power Backup	: Adequate power back-up	
	1 Bedroom	1KVA
	2 Bedroom	2KVA
	3 Bedroom	3 KVA
Security	: Gated Complex	

location map

NOT TO SCALE

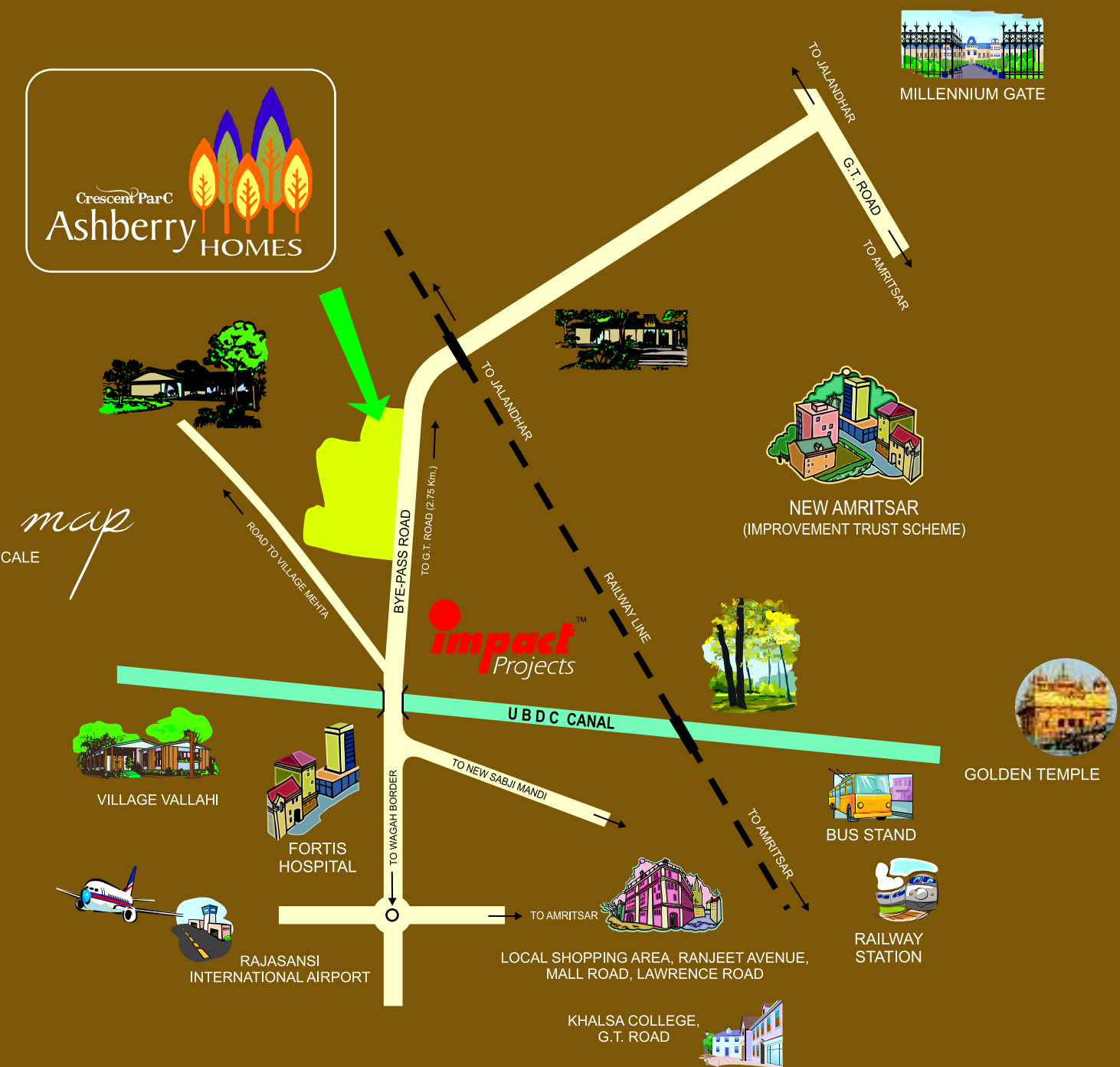



South Asian Real Estate Group popularly known as SARE is a globally reputed real estate company focused on developing residential real estate in India. The company boasts of a strong corporate governance structure, international private equity and an extensive local networking system. With offices spread across London, Singapore and Dubai, aptly managed by a handpicked team of dynamic professionals, its mission is to become the leading vertically integrated real estate developer in India.

Focusing on the rapidly expanding real estate segment, SARE is developing mammoth canvas projects across India in Teir I as well as Teir II cities for maximum reach. Until date it has acquired over 800 acres of land in some of the steadily emerging cities of India: Ghaziabad, Gurgaon, Amritsar, Chennai and Indore.



'Impact' is a well-diversified business group based in Punjab, with varied interests in the Automotive, Non Banking Finance and Housing Industry. The Group has an annual turnover of over Rs.65 crores and has significant business presence in Ludhiana, Jalandhar and Amritsar. The Group's Corporate Office is in Gurgaon.

Constant growth through professional and ethical management is the hallmark of the Impact Group which started in 1991; and in 2002 diversified into the social infrastructure development arena. Its very first project in Amritsar created history by being Punjab's largest licenced housing development project in the Private Sector.

With its commitment to building Amritsar into a modern city, Impact has joined hands with SARE for development on a much larger scale.





site map



One Bedroom Cluster Plan



Crescent ParC
AMRITSAR

One Bedroom Layout



One Bedroom Apartment
Super Area: 738 Sq. Ft
Extra Wide Balcony.

Crescent ParC
Ashberry HOMES
1, 2 & 3 BEDROOM APARTMENTS

Two Bedroom Cluster Plan



Crescent ParC
AMRITSAR

Two Bedroom Layout



Two Bedroom Apartment
Super Area: 1205 Sq. Ft.
Two Bathrooms
Extra wide balconies

Crescent ParC
Ashberry HOMES
1, 2 & 3 BEDROOM APARTMENTS

Three Bedroom Layout



Three Bedroom Apartment
 Super Area: 1405 Sq. ft.
 Two Bathrooms
 Extra Wide balconies

Crescent ParC
 AMRITSAR

Three Bedroom Cluster Plan

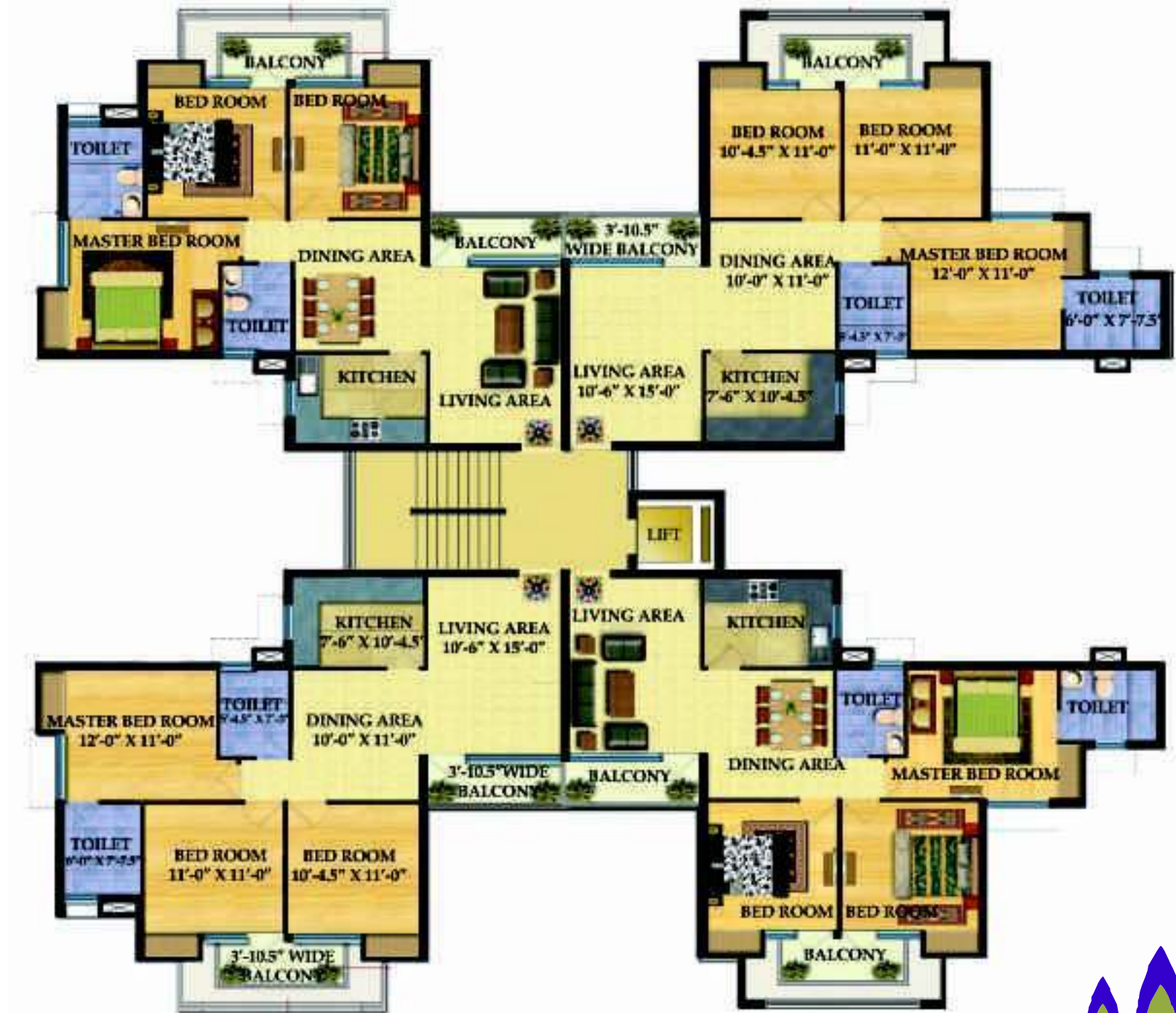

Crescent ParC
Ashberry HOMES
 1, 2 & 3 BEDROOM APARTMENTS

SHOPS



PROPERTY LINKERS

Mobile: +91-9417292777, 9988991234

Phone: +91-183-2502220, 3255577

Crescent ParC
AMRITSAR